

Observation Elevators

Observation elevators will add the aesthetic value and prestige to your building like hotels, shopping centers, office buildings, banks, hospitals and observation towers.

Observation elevators Layout Plan & Standard Dimensions

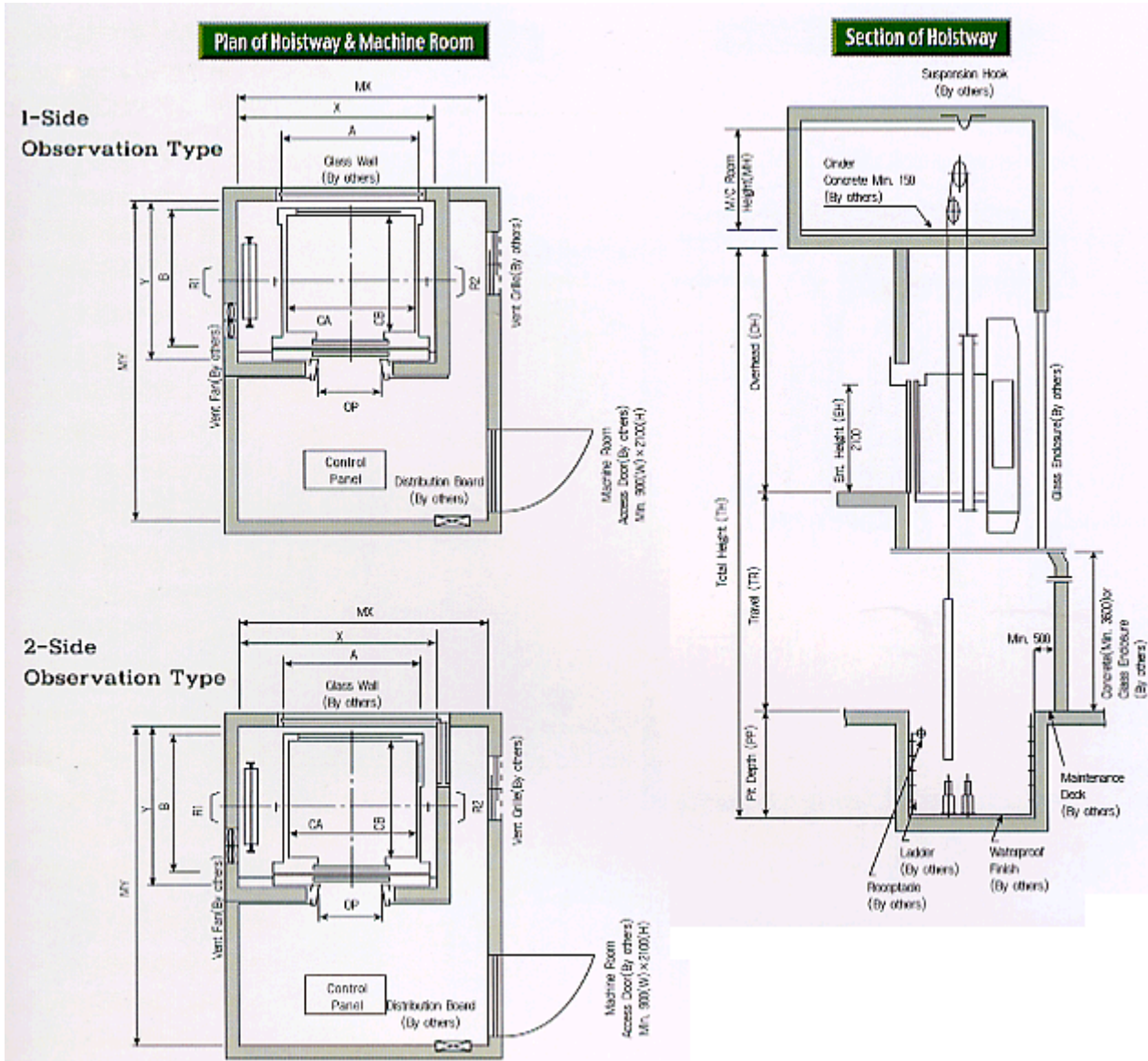

Standard Dimensions & Reactions

(Unit : mm)

| Type | Speed (m/min) | Capacity | | Clear Opening | CAR | | Hoistway | M/C Room | M/C Room Reaction (kg) | |
|---------------------------|-----------------------|----------|------|---------------|-----------|-----------|-----------|-----------|------------------------|-------|
| | | Persons | kg | | OP | Internal | | | External | X x Y |
| | | | | | CA x CB | A x B | | | | |
| 1 Side Observation | 45 60 90 105 | 6 | 450 | 800 | 1400x850 | 1460x1060 | 2200x1410 | 2600x2910 | 3750 | 2600 |
| | | 8 | 550 | 800 | 1400x1030 | 1460x1240 | 2200x1590 | 2600x3090 | 4200 | 2800 |
| | | 9 | 600 | 800 | 1400x1100 | 1460x1310 | 2200x1660 | 2600x3160 | 4300 | 2900 |
| | | 11 | 750 | 800 | 1400x1350 | 1460x1560 | 2200x1910 | 2600x3410 | 4600 | 3150 |
| | | 13 | 900 | 900 | 1600x1350 | 1660x1560 | 2400x1910 | 3000x3410 | 5200 | 3950 |
| | | 15 | 1000 | 900 | 1600x1500 | 1660x1710 | 2400x2060 | 3000x3560 | 5500 | 4450 |
| | | 17 | 1150 | 1000 | 1800x1500 | 1900x1710 | 2850x2060 | 3500x3560 | 7550 | 5500 |
| | | 20 | 1350 | 1000 | 1800x1700 | 1900x1910 | 2850x2260 | 3500x3760 | 8200 | 6200 |
| | | 24 | 1600 | 1100 | 2000x1750 | 2100x1960 | 3050x2310 | 3700x3810 | 8800 | 6950 |
| 2 Side Observation | 45 60 90 105 | 8 | 550 | 800 | 1400x1030 | 1460x1240 | 2200x1590 | 2600x3090 | 4200 | 2800 |
| | | 9 | 600 | 800 | 1400x1100 | 1460x1310 | 2200x1660 | 2600x3160 | 4300 | 2900 |
| | | 11 | 750 | 800 | 1400x1350 | 1460x1560 | 2250x1910 | 2700x3410 | 4700 | 3300 |
| | | 13 | 900 | 900 | 1600x1350 | 1660x1560 | 2450x1910 | 3100x3410 | 5350 | 4050 |
| | | 15 | 1000 | 900 | 1600x1500 | 1660x1710 | 2450x2060 | 3200x3560 | 5650 | 4600 |
| | | 17 | 1150 | 1000 | 1800x1500 | 1900x1710 | 2900x2060 | 3700x3560 | 7700 | 5650 |
| | | 20 | 1350 | 1000 | 1800x1700 | 1900x1910 | 2900x2260 | 3700x3760 | 8350 | 6300 |
| | | 24 | 1600 | 1100 | 2000x1750 | 2100x1960 | 3100x2310 | 3900x3810 | 9000 | 7050 |

Notes:

- i. The capacity in persons is calculated at 68kg/person.
- ii. Machine - room - less elevators are available, if requested.

(Unit : mm)

| Speed (m/min) | Overhaed (OH) | Pit (PP) | M/C Room Height (MH) |
|---------------|---------------|----------|----------------------|
| 45, 60 | 4800 | 1800 | 2200 |
| 90 | 4950 | 2200 | 2400 |
| 105 | 5100 | 2200 | 2400 |

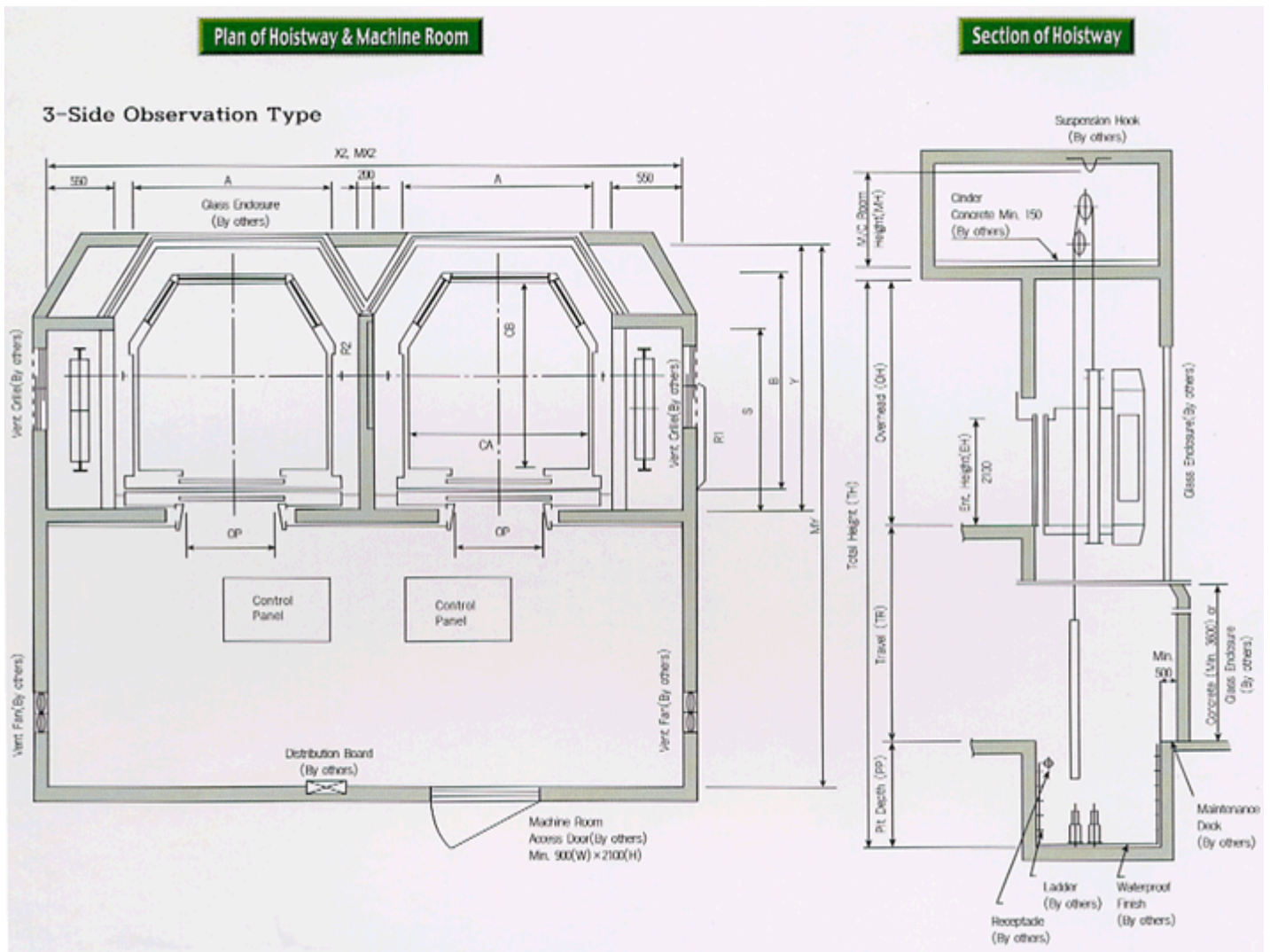

Standard Dimensions & Reactions

(unit : mm)

| Speed (m/min) | Capacity | | Clear Opening | CAR | | Hoistway | | | | M/C Room | | | M/C Room Reaction (kg) | |
|-----------------------|----------|------|---------------|-----------|-----------|----------|-------|-------|------|----------|-------|-------|------------------------|------|
| | Persons | kg | | Internal | External | 1Car | 2Cars | Depth | S | 1Car | 2Cars | Depth | R1 | R2 |
| | | | OP | CAxCB | AxB | X1 | X2 | Y | S | MX1 | MX2 | MY | R1 | R2 |
| 45 60 90 105 | 11 | 750 | 800 | 1400x1450 | 1460x1660 | 2450 | 5100 | 2010 | 1200 | 2900 | 5100 | 3510 | 4900 | 3500 |
| | 13 | 900 | 900 | 1600x1450 | 1660x1660 | 2650 | 5500 | 2010 | 1350 | 3300 | 5500 | 3510 | 5500 | 4050 |
| | 15 | 1000 | 900 | 1600x1600 | 1700x1810 | 2650 | 5500 | 2160 | 1350 | 3300 | 5500 | 3710 | 5750 | 4700 |
| | 17 | 1150 | 900 | 1500x1950 | 1600x2160 | 2650 | 5500 | 2510 | 1600 | 3500 | 5500 | 4010 | 8200 | 6400 |
| | 20 | 1350 | 1000 | 1700x1870 | 1800x2080 | 2850 | 6100 | 2430 | 1600 | 3500 | 6100 | 3930 | 8500 | 6600 |
| | 24 | 1600 | 1000 | 1800x2130 | 1900x2340 | 3050 | 6300 | 2690 | 1600 | 3700 | 6300 | 4190 | 9600 | 7500 |

Note. The capacity in persons is calculated at 68kg/person.

(unit : mm)

| Speed (m/min) | Overhead (OH) | Pit (PP) | M/C Room Height (MH) |
|---------------|---------------|----------|----------------------|
| 45, 60 | 4900 | 2000 | 2200 |
| 90 | 5050 | 2200 | 2400 |
| 105 | 5200 | 2200 | 2400 |

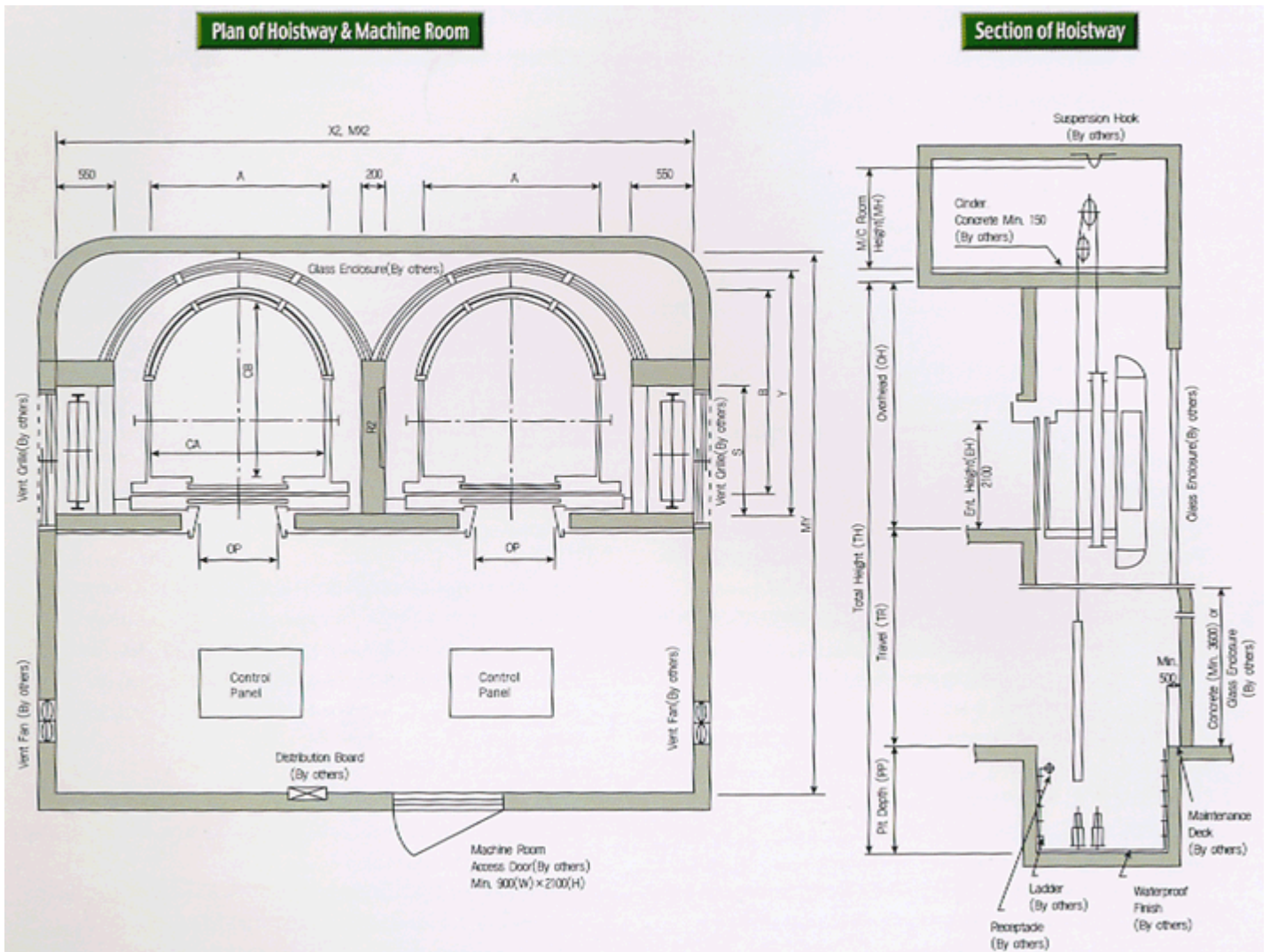

Standard Dimensions & Reactions

(Unit : mm)

| Speed (m/min) | Capacity | | Clear Opening | CAR | | Hoistway | | | | M/C Room | | | M/C Room Reaction (kg) | |
|-----------------------|----------|------|------------------|-----------|-----------|----------|-------|-------|------|----------|-------|-------|---------------------------------|------|
| | | | | Internal | External | 1Car | 2Cars | Depth | | 1Car | 2Cars | Depth | R1 | R2 |
| | Persons | kg | OP | CAxCB | AxB | X1 | X2 | Y | S | MX1 | MX2 | MY | | |
| 45 60 90 105 | 11 | 750 | 800 | 1400x1500 | 1460x1710 | 2500 | 5200 | 2060 | 1200 | 3000 | 5200 | 3560 | 5150 | 3950 |
| | 13 | 900 | 900 | 1500x1600 | 1560x1810 | 2600 | 5400 | 2160 | 1350 | 3300 | 5400 | 3660 | 5700 | 4500 |
| | 15 | 1000 | 900 | 1500x1750 | 1600x1960 | 2600 | 5400 | 2310 | 1350 | 3300 | 5400 | 3810 | 5950 | 4950 |
| | 17 | 1150 | 900 | 1500x1950 | 1600x2160 | 2650 | 5500 | 2510 | 1600 | 3500 | 5500 | 4010 | 8200 | 6400 |
| | 20 | 1350 | 1000 | 1700x1980 | 1800x2190 | 2850 | 5900 | 2540 | 1600 | 3500 | 5900 | 4040 | 8950 | 6950 |
| | 24 | 1600 | 1000 | 1800x2130 | 1900x2340 | 3050 | 6300 | 2690 | 1600 | 3700 | 6300 | 4190 | 9600 | 7500 |

Note. The capacity in persons is calculated at 68kg/person.

(unit : mm)

| Speed (m/min) | Capacity (OH) | Pit (PP) | M/C Room Height (MH) |
|------------------|------------------|----------|-------------------------|
| 45, 60 | 4900 | 2000 | 2200 |
| 90 | 5050 | 2200 | 2400 |
| 105 | 5200 | 2200 | 2400 |